

30W Dual Output Switching Power Supply



GD-30G...

Feature

- High efficiency, high reliability, low cost
- AC input range selected by switch
- Protections: Short circuit/ Over load
- Cooling by free air convection
- LED indicator for power on
- Fixed switching frequency at 23KHz
- Output is isolated from the others
- 1 year warranty
- Dimensions: 129*98*38mm(L*W*H)

Notes:

- All parameters NOT specially mentioned are measured at 230VAC input, rated load and 25°C of ambient temperature.
- Ripple & noise are measured at 20MHz of bandwidth by using a 12" twisted pair-wire terminated with a 0.1μ & 47μf parallel capacitor.

- Each output can within current range. But total output power can't exceed rated load

- The power supply is considered a component which will be installed into a final equipment. The final equipment must be re-confirmed that it still meets EMC directives.

Model		GD-30G	
		CH1	CH2
Output	DC Voltage	15V	15V
	Voltage Tolerance	±1%	±1%
	Rated Current	1A	1A
	Current Range	0.1-1A	0.1-1A
	Rated Power	30W	
	Ripple & Noise	100mVp-p	
	DC Voltage adi. Range	CH1: +10, -5%	
	Setup,Rise,Hold Time	200ms, 50ms, 30ms at full load	
Input	Voltage Range	85~132 VAC/176~264VAC selected by switch 47~63Hz; 120~370VDC	
	AC Current	0.8A/115 VAC 0.45A/230 VAC	
	Efficiency	74%	
	Inrush Current	Cold start 18A/115V 36A/230V	
	Leakage Current	<1mA/240VAC	
Protection	Over Load	105%~150%	
		Protection type: Shut down o/p voltage, recovers automatically after fault condition is removed	
Environment	Working Temp., Humidity	-10°C~+60°C, 20%~90 %RH	
	Storage Temp., Humidity	-20°C~+85°C, 10%~95 %RH	
	Vibration	10~500Hz, 2G 10min./1cycle, period for 60min,each along X, Y, Z axes	
Safety	Withstand Voltage	I/P-O/P: 1.5KVAC I/P-FG: 1.5KVAC O/P-FG: 0.5KVAC	
	Isolation Resistance	I/P-O/P, I/P-FG, O/P-FG:100MΩ/500VDC	
Standards	Safety Standard	Design refer to UL1012	
	EMC Standard	Design refer to FCC Part15 J Conduction Class A	
Others	Weight	0.41Kg	
	Packing	45pcs/17Kgs/1.22CUFT	

Outline and dimension

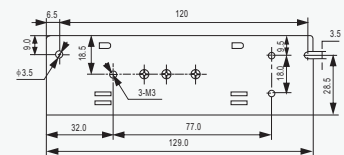
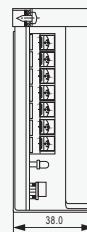
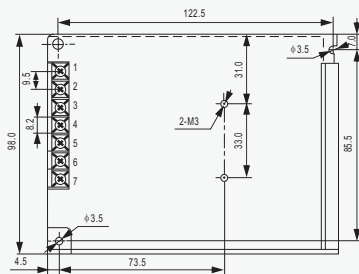

Terminal Pin No. Assignment

Pin No.	Assignment	Pin No.	Assignment	Pin No.	Assignment
1	AC/L	4	DC OUTPUT COM	7	DC OUTPUT +V1
2	AC/N	5	DC OUTPUT +V2		
3	FG	6	DC OUTPUT COM		

■ Derating Curve

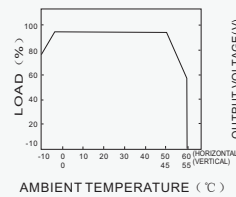

■ Static Characteristics(B)

